

DAC  
in  
Tambaram



மனம் மயங்கும் வீடுகள்  
மத் மயங்கும் விலையில்



# LOCATION MAP

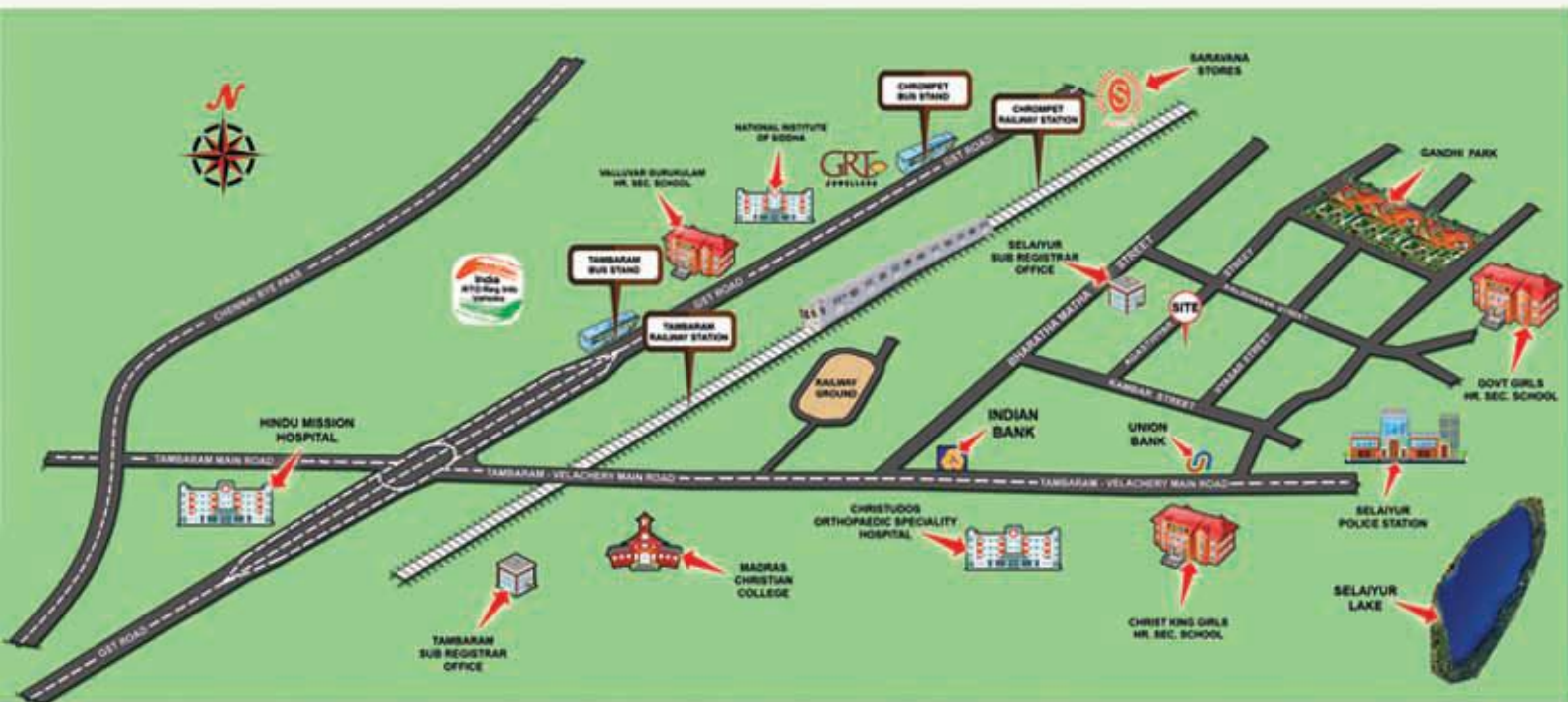

**Site Address: No: 47, Agasthiyar st, Tambaram East.**

## Block A



### GROUND FLOOR PLAN

Flat - G2  
Sq.ft - 1103  
North Facing



Living	- 13'9" x 10'0"
M.Bed room	- 13'9" x 10'6"
G.Bed room	- 11'6" x 12'0"
C.Bed room	- 9'9" x 10'6"
Kitchen/Dining	- 19'6" x 9'3"
C.Toilet	- 9'0" x 4'0"
A.Toilet	- 7'9" x 4'0"
Dressing	- 4'0" x 4'0"

## Block B



### GROUND FLOOR PLAN

Flat - G2  
Sq.ft - 1108  
North Facing

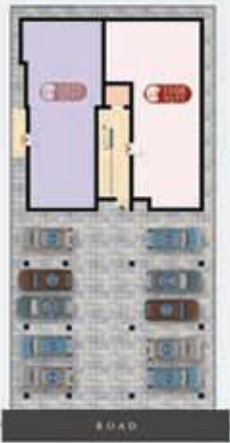

Living	- 16'3" x 11'9"
G. Bed room	- 12'6" x 9'0"
M. Bed room	- 11'9" x 11'9"
C. Bed room	- 10'0" x 15'0"
Kitchen/Dining	- 16'3" x 7'3"
A. Toilet	- 7'0" x 4'0"
C. Toilet	- 7'0" x 4'0"

## Our Specialities...

*Good Planning as per vaasthu*



*Good Elevation by well Qualified Architects*

*Quality Construction by experienced field engineers*

*Well designed framed structure by qualified structural engineers*

*Clear title / Good Locality / Car parking for all flats*

# Specification

-  — *Isolated / Combined Footing, R.C.C Framed structure designed by qualified professional structural Engineer*
-  — *All Interior Walls will be applied with wall putty and finished with premium Ceiling will be finished in Ultra white.*
-  — *Granite top, Stainless steel sink, wall tile upto 2' above granite slab.*
-  — *Entire Flat 2'x2' vitrified tiles Johnson / **Kajaria**\* / Somany / Equivalent Floor. in all bathroom will be 1'x 1' Anti-skid tiles.*
-  — *All Windows are Country wood (or) UPVC openable window with MS safety glass*  
  
*MAIN DOOR: Good Quality of Teak Wood panel finished with mela mine polis. Godrej locks*  
*OTHER DOORS: Membrane Doors with good quality teak frames.*  
*TOILET DOORS: Water Proofing flush door (or) Foam Door.*
-  — *External PVC piping (Finolex / Astral / Prince / Equivalent) and internal CPVC (Astral / Prince / Equivalent). All Fittings will be **Jaquor**\* / equivalent. Ceramic dado tiles upto 7' height.*
-  — *Granite Flooring with SS Handrails*
-  — *Concealed 3-phase Electricity supply with Finolex / Equivalent wiring MCB's, adequate light, fan and sufficient power points, **ROMA**\* Switches sufficient light in common areas. Free inverter wiring.*

\*These are the branded materials used by DAC for Constructions

## Payment Terms

1) Booking Advance	5%	6) On Completion of corresponding slab	5%
2) Within 10 days from booking	10%	7) On Completion of corresponding flat brick work	5%
3) At the time of Agreement (within 20 days from booking)	10%	8) On Completion of plastering	5%
4) On Completion of Basement / UDS registration (within 45 days from booking, which is earlier)	45%	9) On Completion of flooring	2.5%
5) On Completion of stilt slab	10%	10) One Month before handing over the flat	2.5%

## Our Bankers





Promoters & Engineers  
 **dac Promoters**

**Corporate Office:**

**No:19, K - Block, Flat No: A -1, Ground Floor, Annanagar East, Chennai- 600 102.**

**Tel: +91 44 4210 3848**

**Branch Office:**

**No: 123, Gandhi Main Road, Sri Shankara Nagar, Pammal Chennai - 600 075.**

**e-mail: [dacpromoters@gmail.com](mailto:dacpromoters@gmail.com)**

**[www.dacgroups.com](http://www.dacgroups.com)**

**93003 93003**

**Serial No: P003**